

Tinworth Street
Vauxhall SE11

Office Space
Available To Let

1-6 Citadel Place

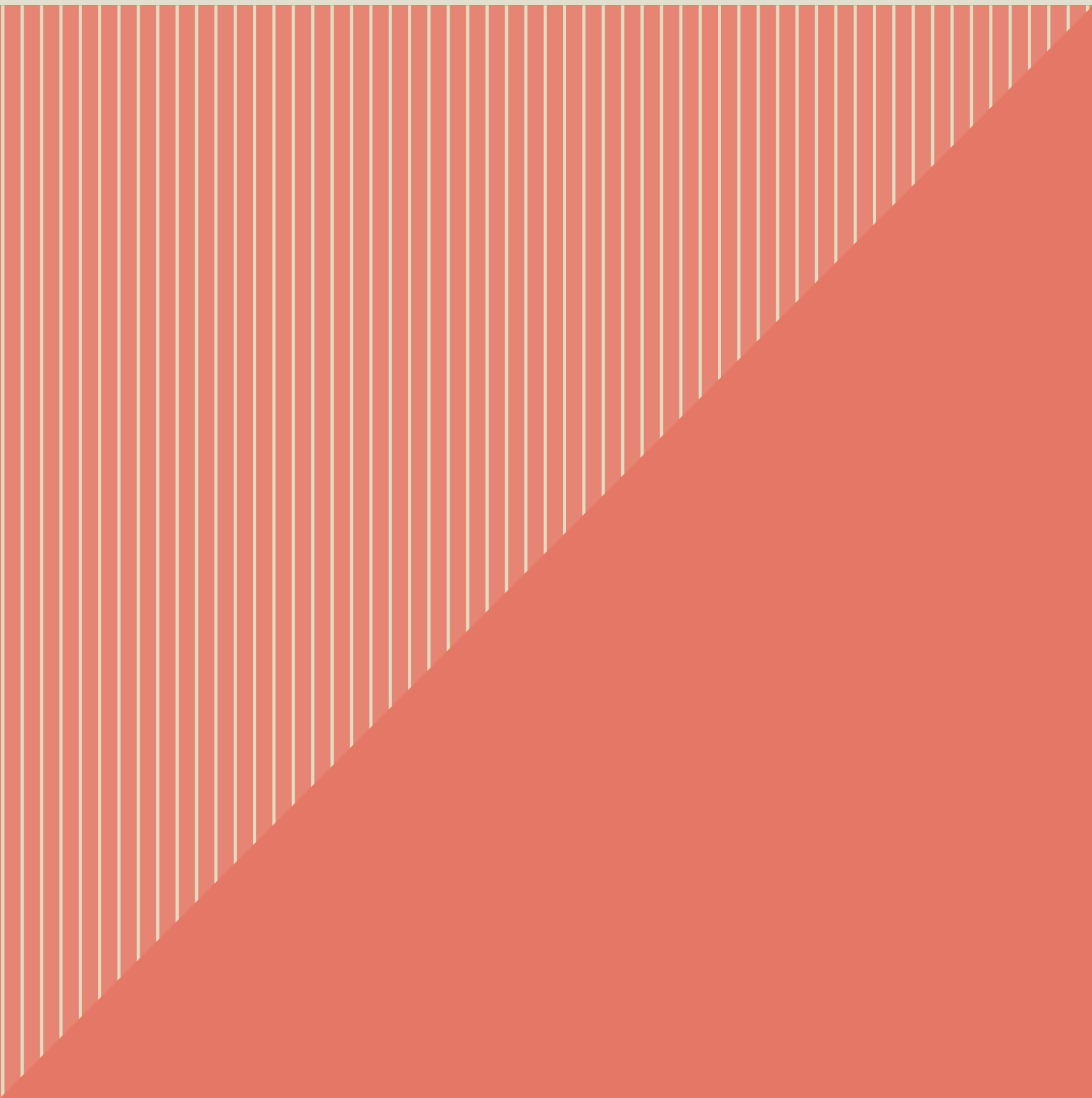



Overview

Smarter working

1-6 Citadel Place provides an ideal opportunity with 26,000 -211,000 sq ft of office space, in a secure campus environment.

The available space is arranged over four floors, and is secured by a perimeter fence and security office.



Secure campus
offering an HQ
opportunity

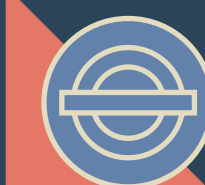

Short walk
from Vauxhall
Station

London Eye

Waterloo

St Paul's Cathedral

The City

The Site

Strategic location

1-6
Citadel
Place

1-6 Citadel Place

Specification

A higher standard

Citadel Place is well located being appropriately 8 minutes walk from Vauxhall Station, which provides access both into Central London and out to the south east.

The campus provides access to on-site facilities including a gym and restaurant, however you are a short walk from a range of surrounding retail & leisure options.

There are a range of unit sizes across the estate to accommodate every need, starting at 26,000 sq ft.



On site restaurant facilities available

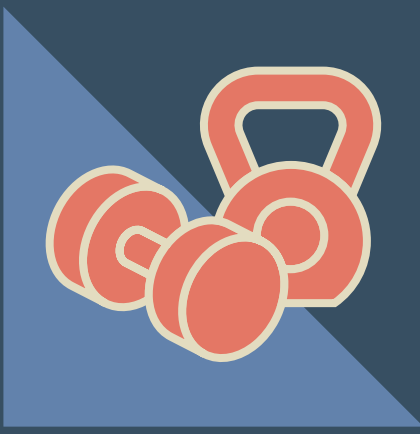

On-site gym facilities

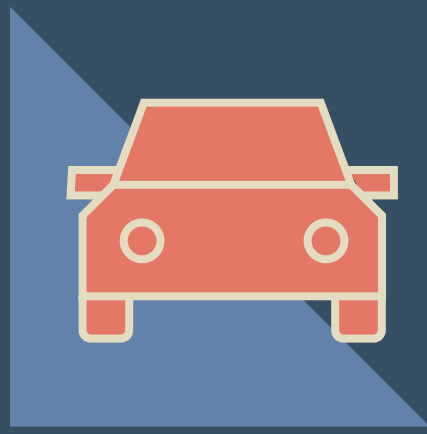

192 above and under-ground car parking spaces



Fully fenced site with security office

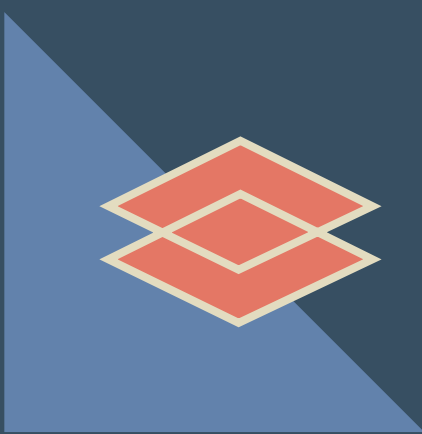

Full access raised floors

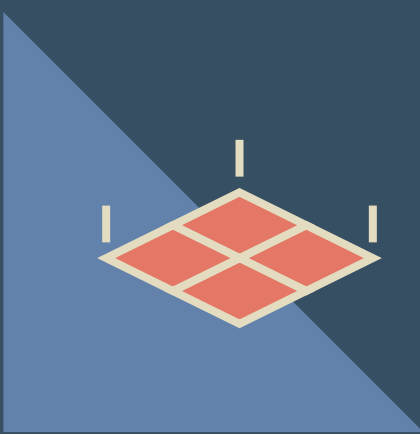

Suspended ceilings

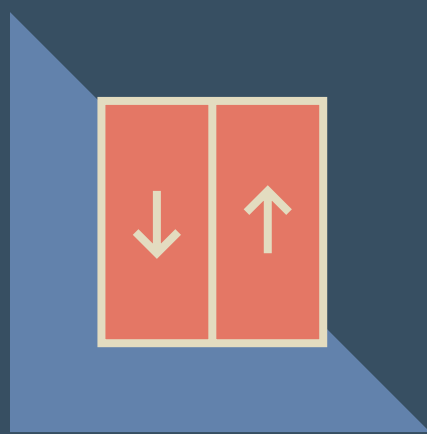

Lifts service all levels



EPC - C

Flexible spaces

Unit A	Sq M	Sq Ft
3rd	2,544	27,383
2nd	2,544	27,383
1st	2,544	27,383
Ground	2,350	25,295
Sub Total NIA	9,982	107,444

Unit B	Sq M	Sq Ft
3rd	2,462	26,501
2nd	2,462	26,501
1st	2,462	26,501
Ground	2,240	24,111
Sub Total NIA	9,626	103,614

Total Office NIA	19,608	211,058
------------------	--------	---------

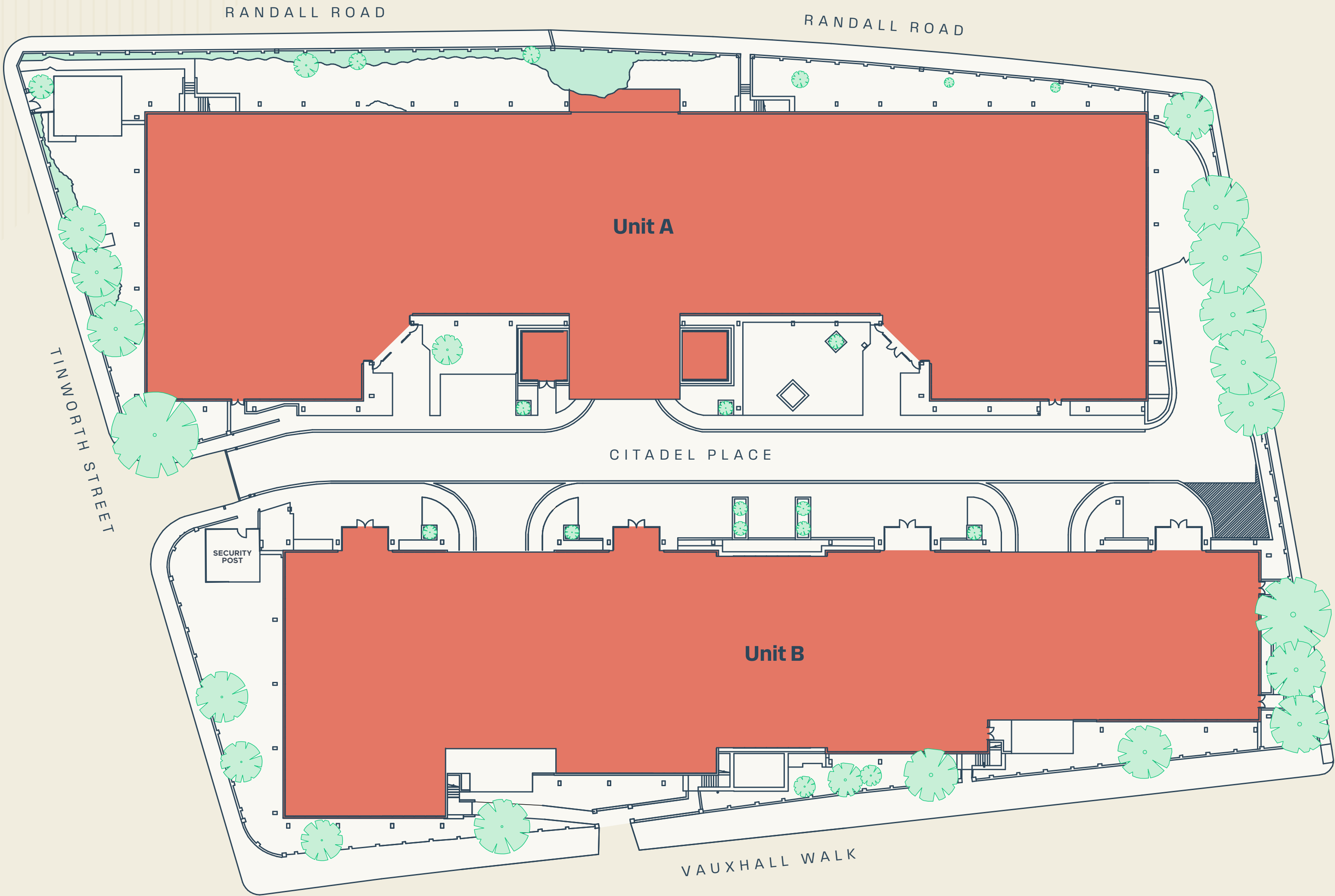

Lifestyle

Vibrant location

The local area is well served by a host of amenities, including restaurants, coffee shops, gyms and relaxing green spaces.



Located just off Albert Embankment, the building occupies a prime position in the vibrant heart of Vauxhall.

The nearby River Thames provides an idyllic waterside environment surrounded by iconic landmarks.

- 1 Vauxhall Pleasure Gardens
- 2 The Black Dog
- 3 Tea House Theatre
- 4 Albert Embankment
- 5 Vanilla Black
- 6 Italo Deli

Location

Get moving

Excellent connectivity is on offer, with Vauxhall transport hub only a short walk away, offering Underground, overground and bus services.

- 1 Vauxhall Bridge
- 2 Vauxhall Station



1-6 Citadel Place

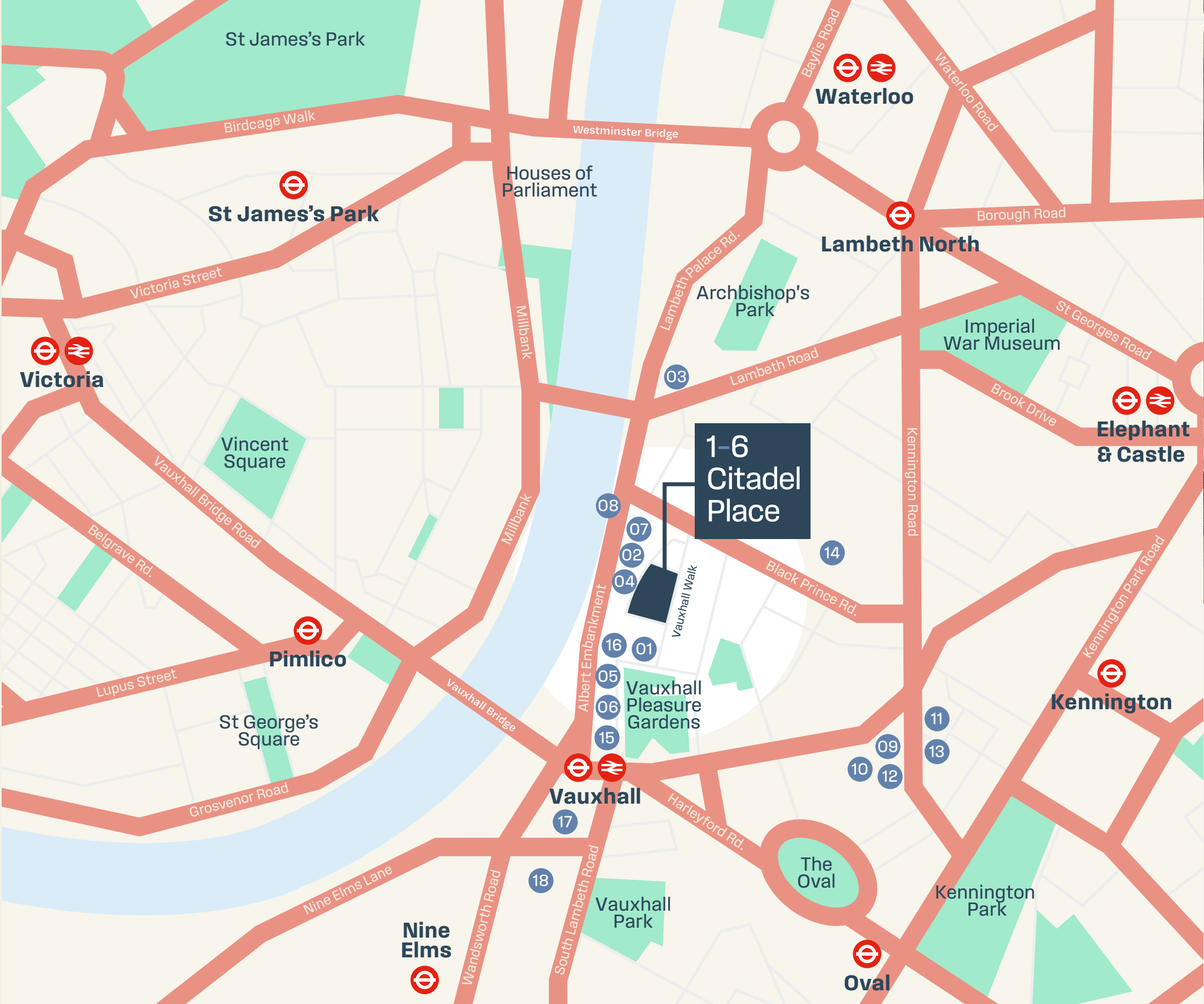

Local Amenities

- | | | | | | |
|---|-----------------|----|----------------|----|--------------------|
| 1 | The Black Dog | 8 | Thamesis Dock | 15 | F45 Vauxhall |
| 2 | TDQ | 9 | Vanilla Black | 16 | Sleven Fitness |
| 3 | The Garden Cafe | 10 | Urban Botanica | 17 | New Motion Fitness |
| 4 | Frida's | 11 | Sally White | 18 | Crossfit Vauxhall |
| 5 | Casa Madeira | 12 | I Due Amici | | |
| 6 | O'Gosht | 13 | Madeira Star | | |
| 7 | Chino Latino | 14 | Foundry Gym | | |



Connections

<div>08</div> <div>minutes walk</div> <div>Vauxhall</div> <div></div>	<div>10</div> <div>minutes</div> <div>Pimlico</div> <div></div>
<div>15</div> <div>minutes</div> <div>London Victoria</div> <div></div>	<div>20</div> <div>minutes</div> <div>Green Park</div> <div></div>

Further information

Get in touch

Viewings

Strictly by appointment through sole agent:

Terms

Upon application.

Guy Bowring
07831 185 728
guy@usp.london

Scott Fisher
07890 572 225
scott@usp.london



1to6citadelplace.com

Important Notice

USP London act for themselves and for the developers of this property, whose agents they are, give notice that: Nothing contained in these particulars or their contents or actions, both verbally or in writing, by USP London form any offer or contract, liability or implied obligation to any applicants, viewing parties or prospective tenants of the property to the fullest extent permitted by law and should not be relied upon as statements or representative of fact. No person in the employment of USP London has authority to make or give any representation or warranty whatever in relation to this property. Any areas of measurements or distances are approximate. The text, photographs and plans are for guidance only, may not be to scale and are not necessarily comprehensive. No assumptions should be made that the property has all necessary planning, building regulation or other consents. USP London has not carried out a survey, nor tested the services, appliances or facilities. All viewing parties must satisfy themselves by inspection or otherwise.

1-6 Citadel Place